

1.1 HSC-A/AR TE 7 TE 16 TE 25 TE 40
TE 7-A TE 30 TE 35

M8 × 40/15	✓	✓	✓	
M8 × 50/15	✓	✓	✓	
M10 × 40/20	✓		✓	✓
M12 × 60/20		✓	✓	✓

1.2 HSC-A/AR TE-C-HSC-B

M8 × 40/15	14 × 40
M8 × 50/15	14 × 50
M10 × 40/20	16 × 40
M12 × 60/20	18 × 60

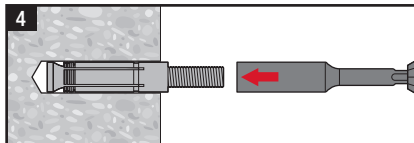
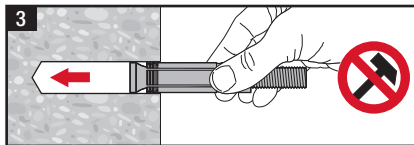
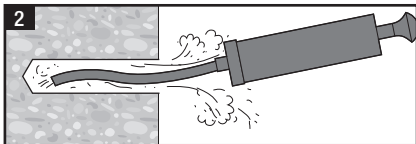

4.1 HSC-A/AR TE-C-HSC-MW

M8 × 40/15	14
M8 × 50/15	14
M10 × 40/20	16
M12 × 60/20	18

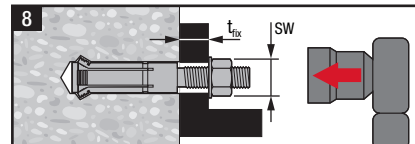
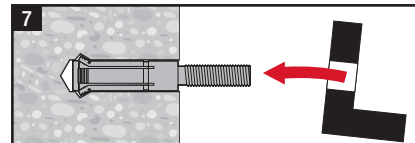
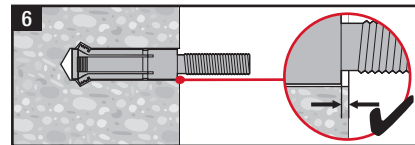
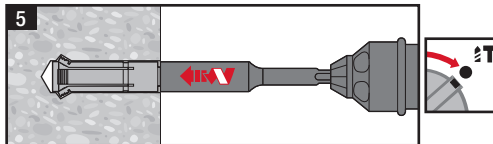

8.1 HSC-A/AR

	t_{fix}	SW	T_{inst}
M8 × 40/15	15	13	10 Nm
M8 × 50/15	15	13	10 Nm
M10 × 40/20	20	17	20 Nm
M12 × 60/20	20	19	30 Nm